

## HI-LOOP MEGA POWER

### RACING DRIVERS' & TRACK MARSHALLS' BRIEFING NOTES

Assemble the track as shown in the diagram and support the track with the track supports supplied on the levels shown.

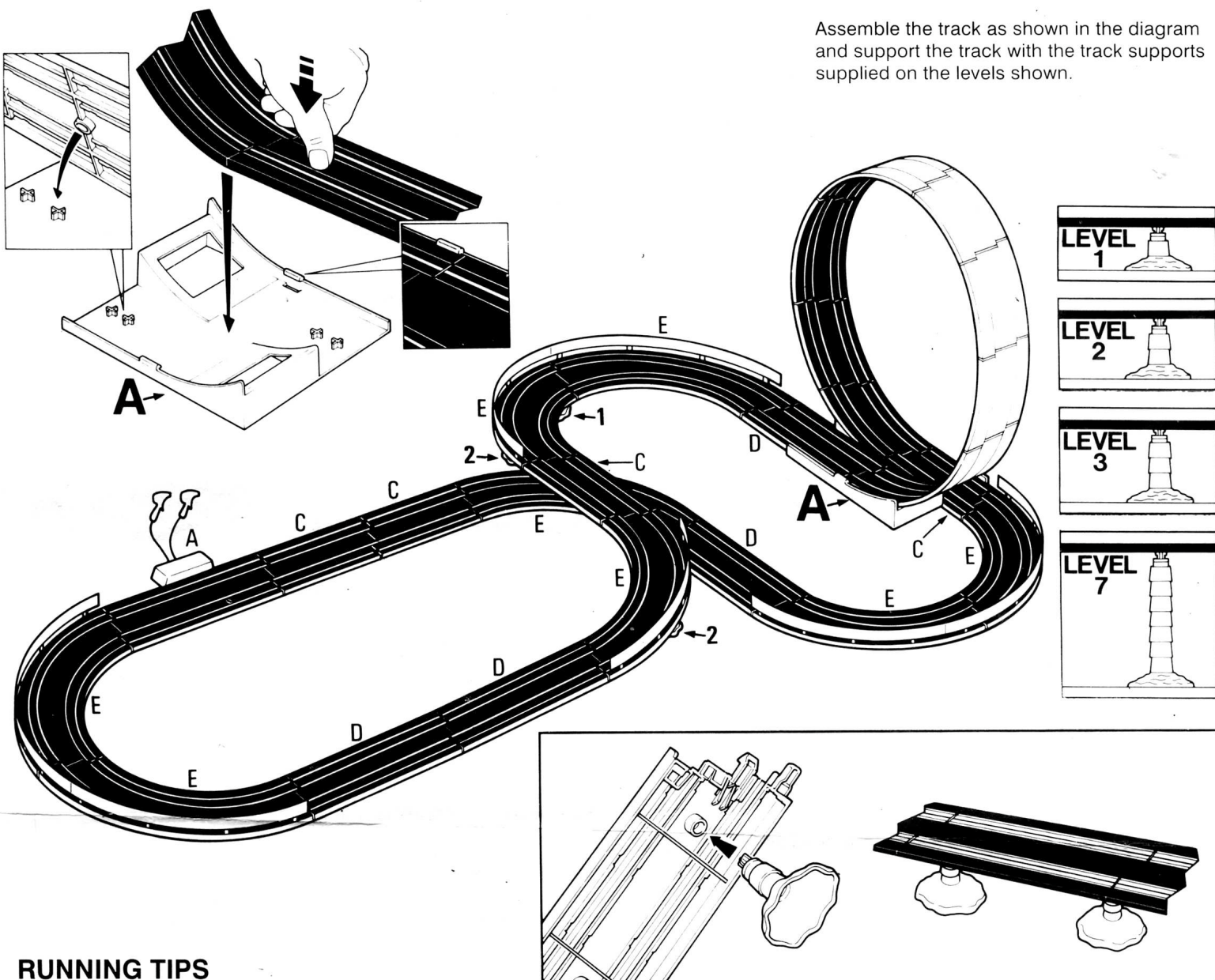

### RUNNING TIPS

- 1 For best results, place the track supports in the positions marked on the Track Layout diagram.
- 2 Remember: SLOW into corners, EASY on the bridge, FAST out of the corners, and FAST into the loop, keeping the power on!

THE TRACK LAYOUT DIAGRAM ALSO SHOWS THE BEST POSITIONS FOR THE CRASH BARRIERS.

### CONTENTS / PARTS LIST

In the event of requesting replacement parts, please quote the part numbers given below. Please see the MicroScalextric Guarantee and Registration Card for further details.

1 x G036 Porsche 911 BP	8 x G105 12" Curves (E)	3 x L7556 Track Support Base
1 x G080 Porsche 911 Demon Tweaks	4 x G103 6" Straights (C)	5 x L7557 Track Support Spacer
1 x C981 RED MegaSound Hand Controller	4 x G102 9" Straights (D)	3 x L7558 Track Support Plug
1 x C982 YELLOW MegaSound Hand Controller	1 x L7574 Track Loop of 8 pieces	10 x L7559 Crash Barriers
1 x C912 Power Unit	1 x L7564 Track Loop Bracket	1 x W1502 Braid/Guide Pin pack
1 x W1503 Power Base Track (A)		

### DOCUMENTS / LEAFLETS \*

- |                                                  |                                                    |
|--------------------------------------------------|----------------------------------------------------|
| 1 x Instruction Leaflet                          | 1 x Scalextric/MicroScalextric Service Dealer list |
| 1 x Hornby Registration Card                     | 1 x MicroScalextric Guarantee                      |
| 1 x Drivers' and Marshalls' Briefing Notes sheet |                                                    |

\*These documents / leaflets can be found on the top of the box with the track sections or in the main box base.

**HORNBY HELPLINE: 01843 299413. MON-FRI 9.00am to 4.00pm**



## DRIVING AND RACING HINTS 'n' TIPS



MicroScalextric cars will require a level of skill to drive them at their best.

- Start slowly for the first few practise laps; exactly like the very best Formula One drivers.
- Accelerate and slow down smoothly. If you accelerate too fast, you will see a lot of spectacular crashes, but you will also lose most of the races.
- Go fast down the straights, slowing down as you enter the corners and accelerate as you come out of them. Take it easy over the bridges.

- Watch your car as you are driving. You will learn to leave your braking to the last second as you approach a bend.

Before asking for help or service, please read the instructions again.

Most operating difficulties can be easily rectified by making a small adjustment to the braid or simply cleaning the affected part.

The most common cause of a malfunction will be a car's worn braid. Also, poor running may be caused by fluff or hair trapped around the moving parts. This may be easily removed with a brush or tweezers.



## FAULT-FINDING GUIDE



PROBLEM	CAUSE	ACTION
Cars will not run	<ul style="list-style-type: none"> <li>● Power Pack not turned on.</li> <li>● Incorrect wiring.</li> <li>● Guide Pin or Braid not making contact with track.</li> <li>● Dirty Braid.</li> <li>● Dirty Track.</li> <li>● 240V household outlet not working.</li> <li>● Overload protector tripped due to short circuit or overheating.</li> <li>● Faulty Power Pack.</li> <li>● Faulty Hand Controller.</li> <li>● Faulty Car.</li> </ul>	<ul style="list-style-type: none"> <li>● Turn on the power at the mains.</li> <li>● Check wiring from hand controllers to the track and the power pack.</li> <li>● Position car with its guide pin in the slot between the metal rails. Bend braids slightly to make contact with the metal rails.</li> <li>● Replace braid or guide pin assembly (see main instructions leaflet for guidance).</li> <li>● Wipe metal rails clean with a lint-free cloth – DO NOT USE SANDPAPER, OTHER ABRASIVE MATERIALS OR LIQUID.</li> <li>● Change to another 240V outlet.</li> <li>● Unplug the power unit, or switch off at the mains. After 30-45 seconds, the overload protector will reset and you can continue racing. Check the track and cars to ensure the cause of the short circuit has been removed.</li> <li>● IMPORTANT: NEVER ATTEMPT TO OPEN POWER PACK.</li> <li>● Swap hand controller to other track. If still not working, replace hand controller.</li> <li>● Only after carrying out all of the above and your cars will still not run should you call the Hornby Helpline.</li> </ul>
Cars run slowly or erratically	<ul style="list-style-type: none"> <li>● Dirty track.</li> <li>● Dirty or worn braid.</li> </ul>	<ul style="list-style-type: none"> <li>● Wipe metal rails clean with a lint-free cloth. NEVER USE SANDPAPER, OTHER ABRASIVE MATERIALS OR LIQUID.</li> <li>● Replace braid (see main instructions leaflet for guidance).</li> </ul>
Excessive crashes	<ul style="list-style-type: none"> <li>● Twisted track.</li> <li>● Worn guide pin.</li> <li>● Incorrect braid position.</li> <li>● Poor driving technique.</li> </ul>	<ul style="list-style-type: none"> <li>● Straighten track making sure that bridges etc. are well supported.</li> <li>● Replace guide pin (see main instructions leaflet for guidance).</li> <li>● Flatten braid onto the chassis (see main instructions leaflet for guidance).</li> <li>● SLOW DOWN!</li> </ul>

**HORNBY HELPLINE: 01843 299413. MON-FRI 9.00am to 4.00pm**